



MOUNT KIT

Toyota Tundra
2007 - 2021

INSTALLATION MANUAL

DO NOT USE OR OPERATE THIS EQUIPMENT UNTIL THIS MANUAL
HAS BEEN READ AND THOROUGHLY UNDERSTOOD

Please visit www.snowplows.hiniker.com to access the most recent version

Hiniker Company
58766 240th Street
Mankato, MN 56001
800-433-5620

PART NUMBER 2512507 Rev B
October 6, 2023





IMPORTANT: Read the Snowplow Operator's Manual before assembling this kit.

Minimum Vehicle Recommendations	
MFR Snowplow Prep Package	REAR BALLAST - 300 lbs. when plow is attached. Secure Weight Behind Rear Wheels.

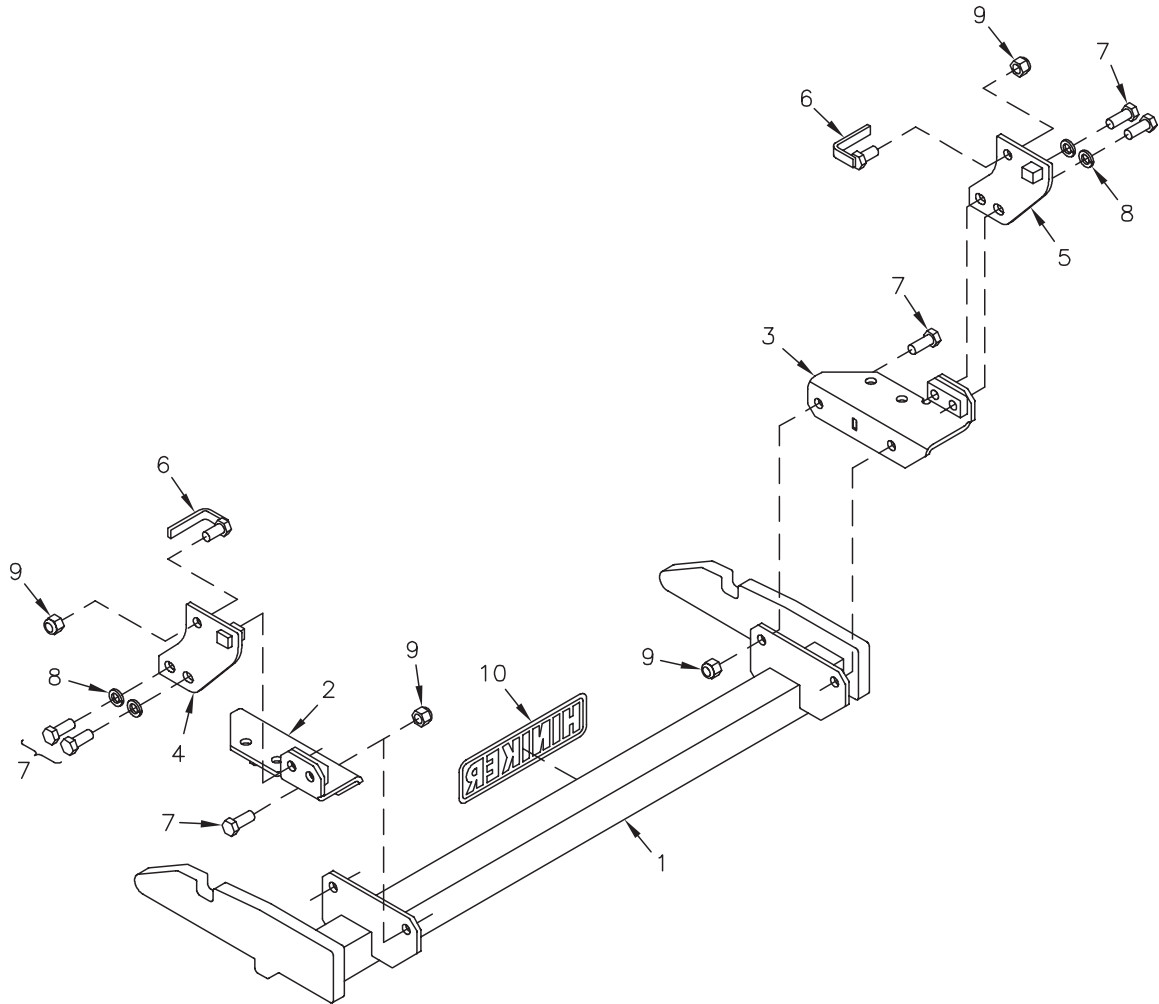

Mount Kit 25012508

DWG. NO. 6132

REF. NO.	PART NUMBER	DESCRIPTION	QTY.	REF. NO.	PART NUMBER	DESCRIPTION	QTY.
1	25012492	Prong Weldment	1	8	25012500	Bolt Weldment	2
2	25012494	LH Bracket Weldment	1	9	950-001-111	Hex Head Cap Screw 1/2-13 x 1 1/4 Gr. 5	6
3	25012499	RH Bracket Weldment	1	10	950-001-125	Hex Head Cap Screw 1/2-13 x 1 1/2 Gr. 5	4
4	25012504	LH Side Plate Weldment	1	11	952-001-004	Lock Washer 1/2 Inch	4
5	25012505	RH Side Plate Weldment	1	12	951-003-009	Lock Nut 1/2-13 Nylon Insert	8
6	25012552	LH Side Rear Bracket	1	13	25010008	Hiniker Decal	1
7	25012553	RH Side Rear Bracket	1		25012506	Bolt Bag	1

All hardware should be tightened only enough to ensure safety during assembly. Fully tighten all hardware after entire assembly is completed.

GRADE 5 TYPE B & F LOCK NUT TORQUE VALUES

Size	Ft-lbs.	N-m
5/16"	13-18	17-25
3/8"	23-33	31-44
1/2"	58-82	79-112
5/8"	117-165	158-223

GRADE 5 BOLT TORQUE VALUES*

Size	Ft-lbs.	N-m
1/4"	8-12	11-16
3/8"	29-41	39-56
1/2"	73-103	99-140
5/8"	146-206	198-279

* Applications without lock nuts

1. Unbolt the tow hooks from the frame rails at the front of the vehicle and save the hardware for installation of the mount kit bracket.

The tow hooks cannot be reinstalled with this kit and should be returned to the vehicle owner for reinstallation if the mount kit is removed from the truck in the future.

2. Use a small cutting disc to trim the front corners off both sides of the truck splash shield along the lines shown in the following two photos.



Shield On Truck

PHOTO NO. DCP1404

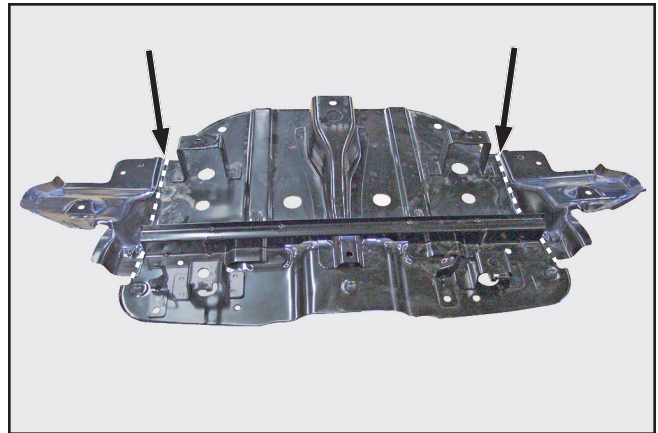

Shield Removed From Truck

PHOTO NO. DCP1411

Raise the LH and RH brackets to the bottom of the frame rails and loosely thread two tow hook bolts through holes in the brackets and into the rails to hold the brackets in place.

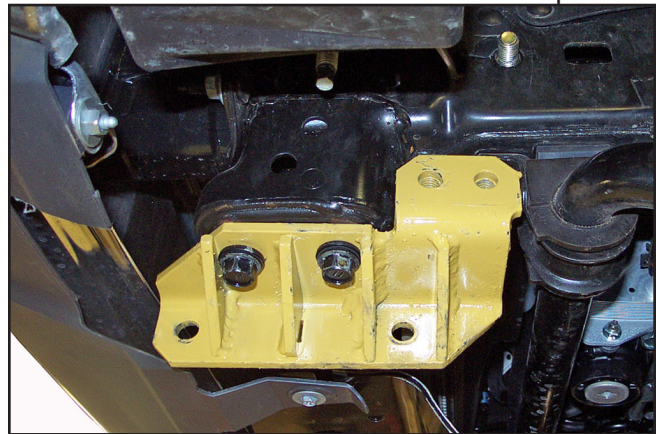

PHOTO NO. DCP1570

3. Begin installation of the LH and RH side plate weldments by first looping a bolt weldment through holes in the outside of the vehicle rails.

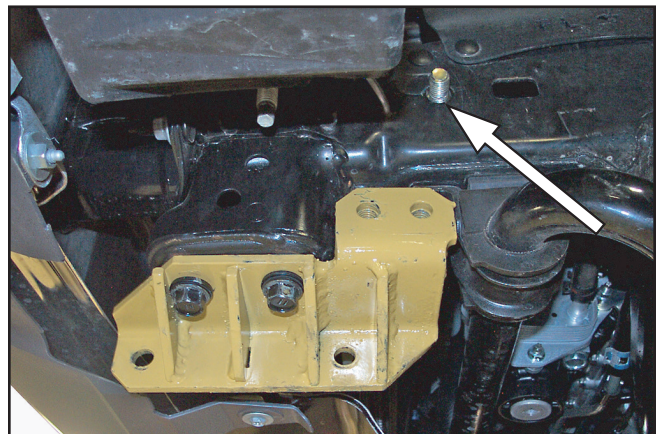

PHOTO NO. DCP1571

Slide the side plate onto the bolt so that the stop block on the plate enters the rectangular hole in the rail, then thread a 1/2" lock nut onto the bolt to secure the plate.

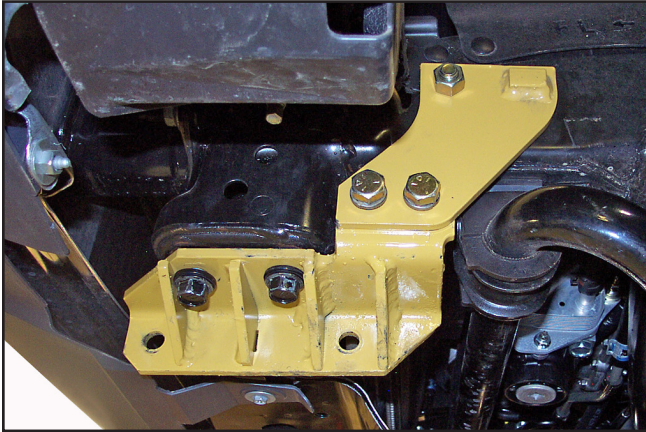

PHOTO NO. DCP1569

Fasten the lower holes of the side plates to threaded holes in the LH and RH brackets with two 1/2" x 1 1/4" hex bolts and lock washers per side.

Fully tighten the four tow hook bolts into the vehicle frame.

4. Lift the prong weldment up between the brackets on the vehicle, then insert four 1/2" x 1 1/2" bolts directed from the outside in.

Slide the LH and RH rear brackets onto the ends of the bolts before loosely threading lock nuts onto the bolts.



PHOTO NO. DCP1560

Push the rear of the brackets up against the bottom of the vehicle frame and outward in the recessed pocket of the frame before drilling 1/2" diameter holes into the vehicle frame through holes in the brackets.

Fasten the brackets to the frame with 1/2" x 1 1/4" hex bolts and lock nuts.

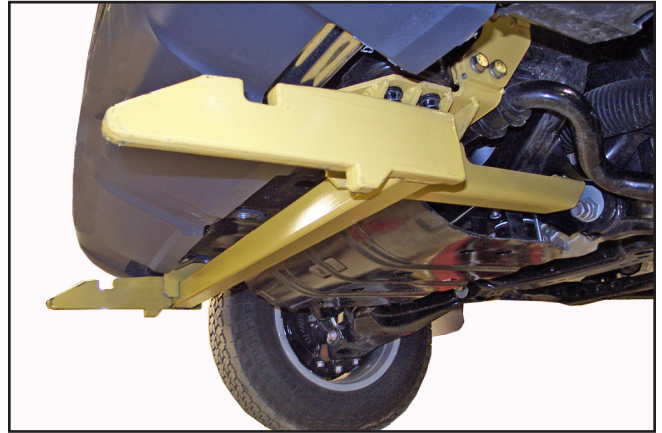

PHOTO NO. DCP1559

Finish installation of the kit by fully tightening all hardware to the specified torque values.

The bottom edges of the prongs should measure about 10" above the ground.