

Hiniker Company
 58766 240th St.
 P.O. BOX 3407
 Mankato, MN 56002

VEHICLE INSTALLATION INSTRUCTIONS
 FORD 4 X 4: 1980 - 1991 F150 - 250 - 350

INSTRUCTION SHEET NO: 25013174

April 4, 2012



IMPORTANT: Read the Snowplow Operator's Manual before assembling this kit.

MINIMUM VEHICLE RECOMMENDATIONS	
MFR Snowplow Prep Package HD Alternator HD Battery HD Front Springs	REAR BALLAST - 500 lbs. when plow is attached. Secure Weight Behind Rear Wheels.

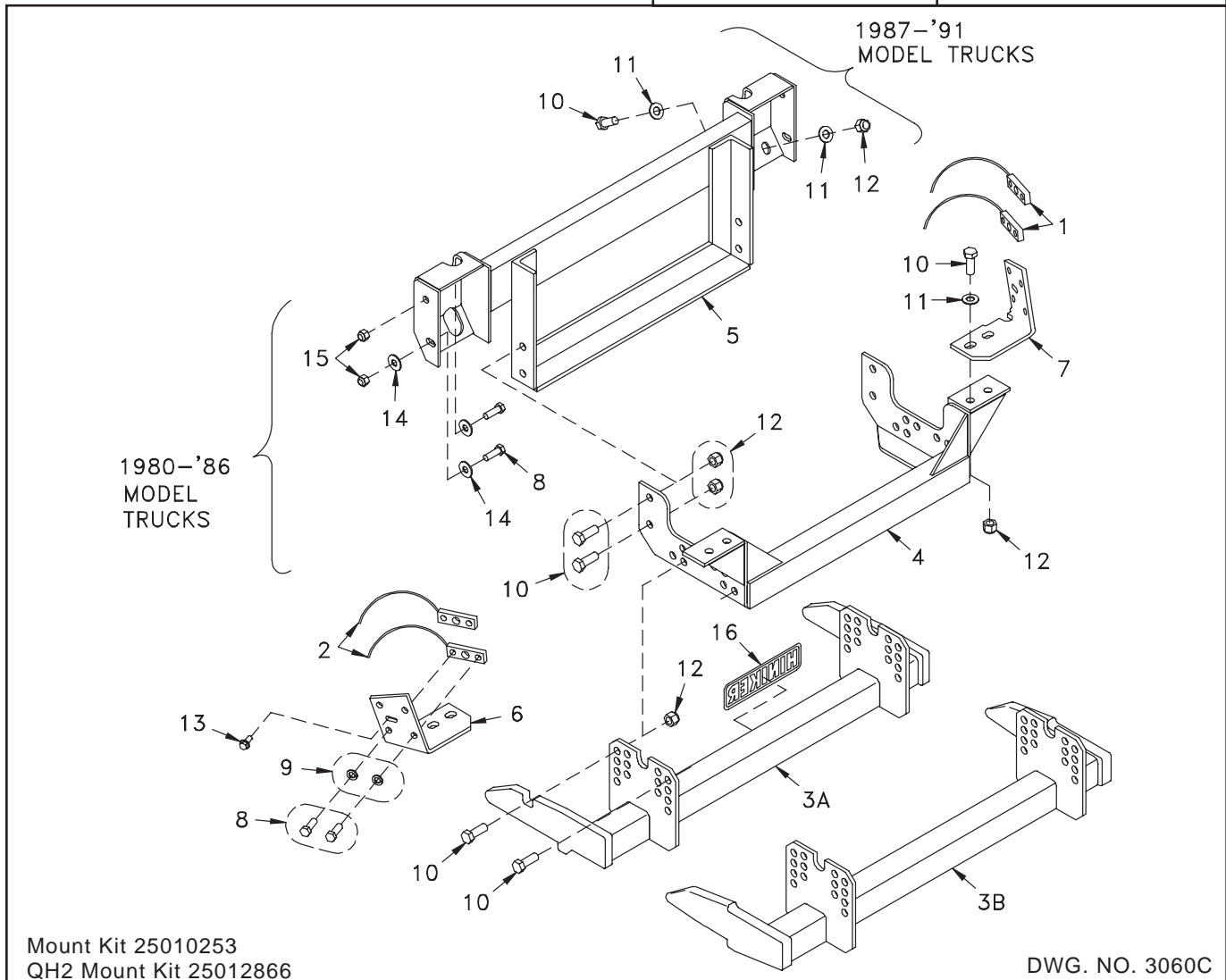

Mount Kit 25010253
 QH2 Mount Kit 25012866

DWG. NO. 3060C

REF. NO.	PART NUMBER	DESCRIPTION	QTY.	REF. NO.	PART NUMBER	DESCRIPTION	QTY.
1	25010173	RH Nut Weldment	2	9	952-001-004	Lock Washer 1/2 Inch	8
2	25010174	LH Nut Weldment	2	10	950-001-132	Hex Head Cap Screw 5/8-11 x 1 3/4 Gr. 5	18
3A	25010177	Prong Weldment	1	11	952-003-003	SAE Flat Washer, 5/8 Inch	8
3B	25012896	Prong Weldment - QH2	1	12	060756	Lock Nut 5/8-11 Nylon Insert	18
4	25010488	Mount Frame Weldment	1	13	950-005-026	Self Tapping Screw 3/8-16 x 1 Hex Washer Head	2
5	25010266	Front Mount Weldment	1	14	952-002-005	Flat Washer 1/2 Inch	6
6	25010272	LH Bracket	1	15	951-003-009	Lock Nut 1/2-13 Nylon Insert	4
7	25010273	RH Bracket	1	16	25010008	Hiniker Decal	1
8	950-001-125	Hex Head Cap Screw 1/2-13 x 1 1/2 Gr. 5	12	25011162	Bolt Bag		

All hardware should be tightened only enough to ensure safety during assembly. Fully tighten all hardware after entire assembly is completed.

GRADE 5 TYPE B & F LOCK NUT TORQUES

Size	Ft-lbs.	N-m
5/16"	13-18	17-25
3/8"	23-33	31-44
1/2"	58-82	79-112
5/8"	117-165	158-223

GRADE 5 BOLT TORQUES*

Size	Ft-lbs.	N-m
1/4"	8-12	11-16
3/8"	29-41	39-56
1/2"	73-103	99-140
5/8"	146-206	198-279

* applications without lock nuts

1. Turn front wheels to the left to aid in assembly.

Remove the front bumper from the truck.

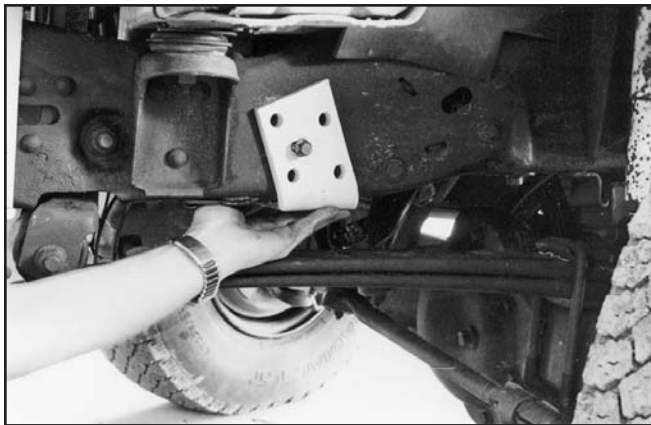

PHOTO NO. 3473

Loosely attach LH and RH brackets to the truck frame by threading 3/8 inch X 1 inch self-tapping screws into existing holes at location shown.

2. Carefully lift mount frame weldment into position under the vehicle's radiator.



PHOTO NO. 3474

Bolt mount frame weldment to LH and RH brackets with 5/8 inch X 1 3/4 inch bolts, flat washers and lock nuts.

3. Fasten the front mount weldment onto the vehicle frame by one of two procedures:

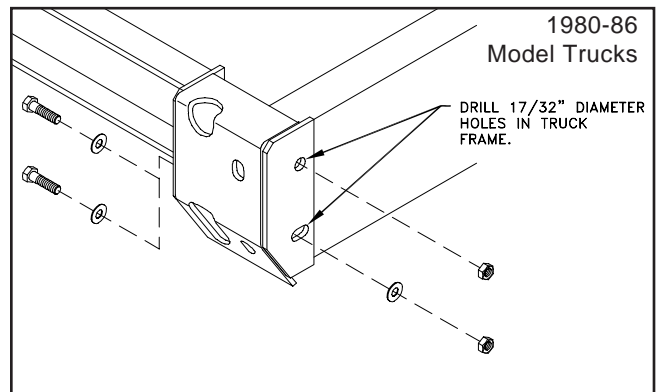

DWG NO. 3160

Hold weldment tight against the top and end of frame members and drill four 17/32 inch diameter holes into the side of the two frame members through existing holes in front mount weldment.

Fasten each side with two 1/2 inch X 1 1/2 inch hex bolts, flat washers and lock nuts. Install bolts from inside of vehicle rails, with a washer under each bolt head.

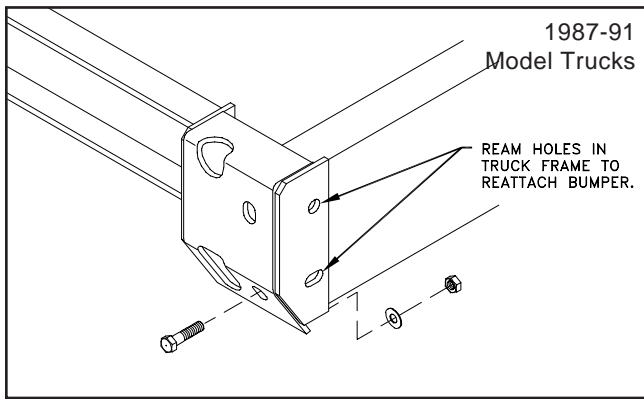

DWG NO. 3161

Bolt front mount weldment to the front of vehicle frame members through existing holes with 5/8 inch X 1 3/4 inch hex bolts, flat washers and lock nuts.

4. Bolt front mount weldment to mount frame weldment with 5/8 inch X 1 3/4 inch hex bolts and lock nuts through the holes in mount frame at location 1.



PHOTO NO. 3476

5. Push LH and RH brackets as far back as possible and tighten all hardware.

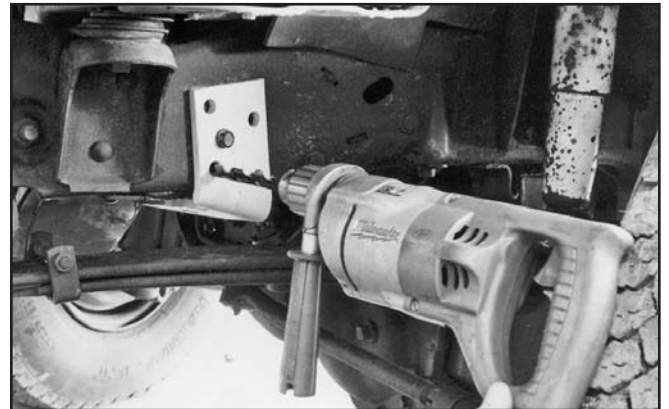

PHOTO NO. 3477

Drill four 17/32 inch diameter holes into each frame member through existing holes in brackets.

NOTE: Frame members are not shown in these photos for better clarity.



PHOTO NO. 3478

Insert LH and RH nut bars into vehicle frame to match drilled holes.

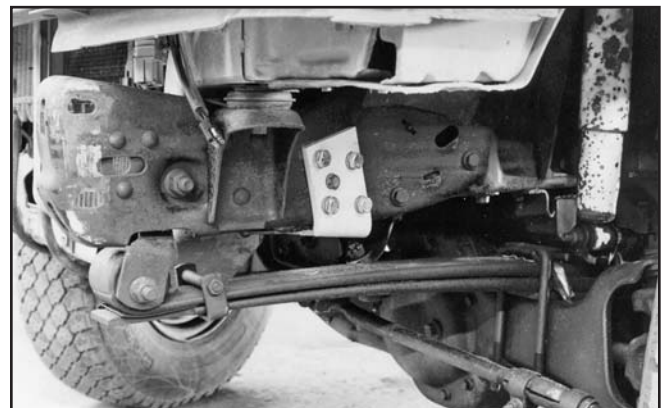

PHOTO NO. 3479

Bolt brackets in place with 1/2 inch X 1 1/2

inch hex bolts and lock washers.

6. Bolt prong weldment to mount frame weldment with 5/8 inch X 1 3/4 inch hex bolts and lock nuts through the holes in mount frame at location 2.

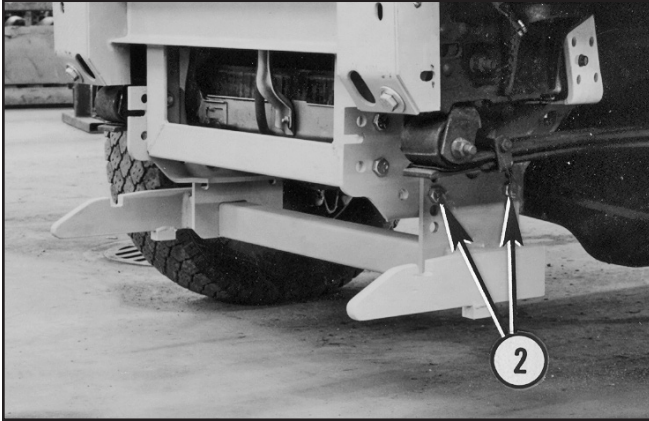

PHOTO NO. 3480

Bottom edges of the prongs should measure about 10 inches above the ground. Ideally, the prongs should lift the plow frame slightly when attaching the plow.



PHOTO NO. 3481

7. Fully tighten all hardware.
8. Reattach the front bumper onto the truck.