

VEHICLE INSTALLATION INSTRUCTIONS  
 FORD F150 4 X 4: 2004 - 2008

Hiniker Company  
 58766 240th St.  
 P.O. BOX 3407  
 Mankato, MN 56002

INSTRUCTION SHEET NO: 25011510 REV B

April 16, 2009



**IMPORTANT: Read the Snowplow Operator's Manual before assembling this kit.**

MINIMUM VEHICLE RECOMMENDATIONS	REAR BALLAST - 500 lbs. when plow is attached. Secure Weight Behind Rear Wheels.
* Regular Cab 4 X 4 144.5" WB, 8.0' pickup box, or Super Cab 4 X 4 163.0" WB, 8.0' pickup box * Snowplow Prep Package * Heavy Duty Payload Package	

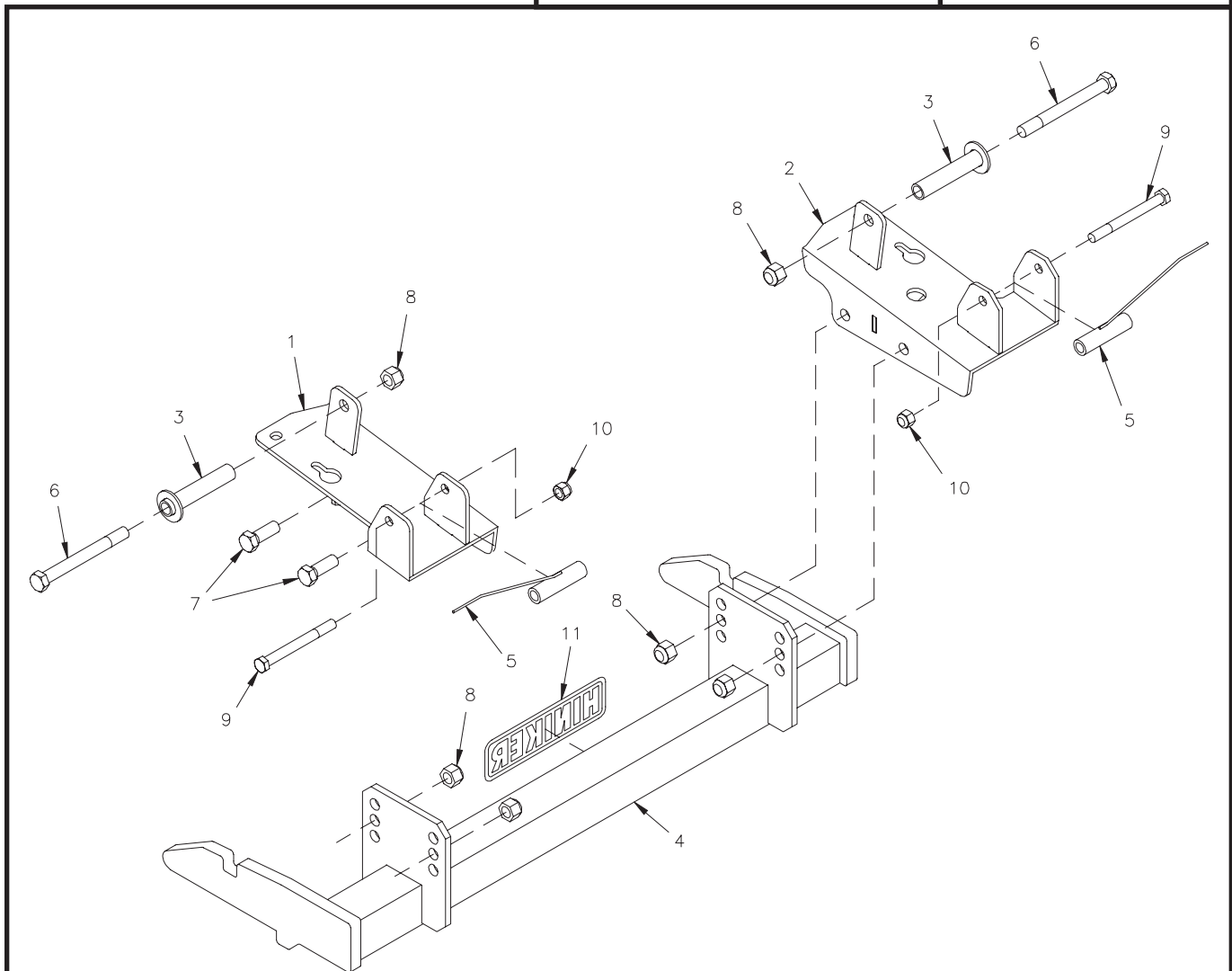

Mount Kit No. 25011509

DWG NO. 5357A

REF. NO.	PART NUMBER	DESCRIPTION	QTY.	REF. NO.	PART NUMBER	DESCRIPTION	QTY.
1	25011517	LH Bracket Weldment	1	7	950-001-132	Hex Head Cap Screw 5/8-11 X 1 3/4 Gr. 5	4
2	25011518	RH Bracket Weldment	1	8	060756	Lock Nut 5/8-11 Nylon Insert	6
3	25011519	Front Spacer Bushing Weldment	2	9	950-001-060	Hex Head Cap Screw 1/2-13 X 5 Gr. 5	2
4	25010491	Prong Weldment	1	10	951-003-009	Lock Nut 1/2-13 Nylon Insert	2
5	25011521	Rear Spacer Bushing Weldment	2	11	25010008	Hiniker Decal	1
6	950-001-161	Hex Head Cap Screw 5/8-11 X 6 Gr. 5	2		25011524	Bolt Bag	1

All hardware should be tightened only enough to ensure safety during assembly. Fully tighten all hardware after entire assembly is completed.

**GRADE 5 TYPE B & F LOCK NUT TORQUES**

Size	Ft-lbs.	N-m
5/16"	13-18	17-25
3/8"	23-33	31-44
1/2"	58-82	79-112
5/8"	117-165	158-223

**GRADE 5 BOLT TORQUES\***

Size	Ft-lbs.	N-m
1/4"	8-12	11-16
3/8"	29-41	39-56
1/2"	73-103	99-140
5/8"	146-206	198-279

\* applications without lock nuts

 **IMPORTANT: Loosen, but do not remove rear tow hook bolts from the vehicle when installing this kit. If both bolts are removed at the same time, internal nut bars may fall into the vehicle frame rails, and the front bumper of the truck must be removed for retrieval.**

1. Remove both tow hooks from the truck by removing front bolts, then loosening, but not removing, rear bolts. Slide tow hooks off of rear bolts.



PHOTO NO. 4228

Identify LH and RH bracket weldments from the mount kit. Assemble brackets to the bottom of the vehicle frame rails by first sliding a bracket over the rear tow hook bolt, then reassembling a tow hook over the same bolt.



PHOTO NO. 4229

Align the front hole in the tow hook and mount bracket with the front hole in the vehicle frame and internal nut bar. Reinstall the front tow hook bolt to secure the assembly.

2. Insert 5/8 inch X 6 inch hex bolts into the washer end of the two front spacer bushing weldments.



PHOTO NO. 4230

Install the spacers and bolts into holes through the outer walls of the vehicle rails to fasten front tabs of the LH and RH bracket weldments to the vehicle. Secure the assembly with 5/8 inch lock nuts threaded onto the bolts.

3. Drill a 17/32 inch diameter hole into the inner and outer wall of each vehicle side rail through holes in the rear tabs of the LH and RH bracket weldments.



PHOTO NO. 4231

On each side of the vehicle, insert a rear spacer bushing weldment from the kit into the slotted hole in the vehicle frame above the drilled holes. Bend an offset into the handle of the spacer so that the bushing is in line with the drilled holes.



PHOTO NO. 4232

Install a 1/2 inch X 5 inch hex bolt through the drilled holes and spacer to fasten the rear tabs of the LH and RH bracket weldments to the vehicle. Secure the assembly with a 1/2 inch lock nut.

Bend wire handles on the spacers to an out of the way position.

4. Fasten the mount plates of the prong weldment to holes in the LH and RH bracket weldments with four 5/8 inch X 1 3/4 inch hex bolts and lock nuts.



PHOTO NO. 4233

Bottom edges of the prongs should measure about 10 inches above the ground. Ideally, the prongs should lift the plow frame slightly when driving into the plow.

5. Fully tighten hardware to specified torques.

### HEADLIGHT REMOVAL

The following instructions are reprinted from the 2004 Ford F150 owners manual. Follow these instructions when installing the mount kit headlight adapter.

1. At the top and inboard side of the headlamp, loosen the three retaining screws.

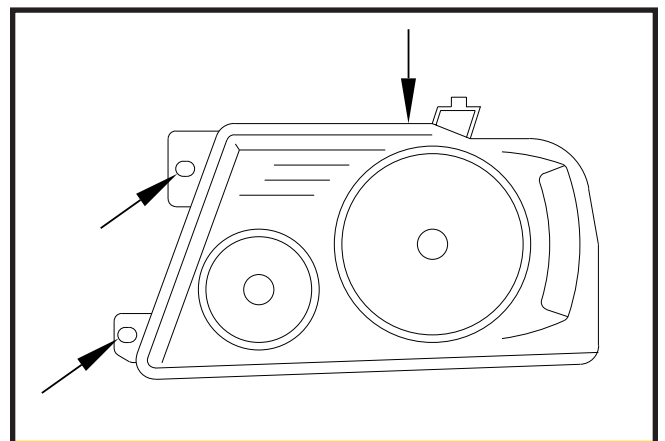

DWG NO. 5358

2. Once the three retaining screws have been removed, disengage the tab at the top center of the headlamp assembly by lifting it up.
3. Slide the headlamp assembly forward disconnecting the snap attachment at the fender and disconnect the electrical connector from the bulb by pulling rearward.