

| REV. | ECO NO. | DATE | BY | DESCRIPTION | CK. BY |
|------|---------|---------|----|----------------------------------|--------|
| A | 8603 | 3-25-20 | CH | ADD: 950-001-084, 951-001-005... | |

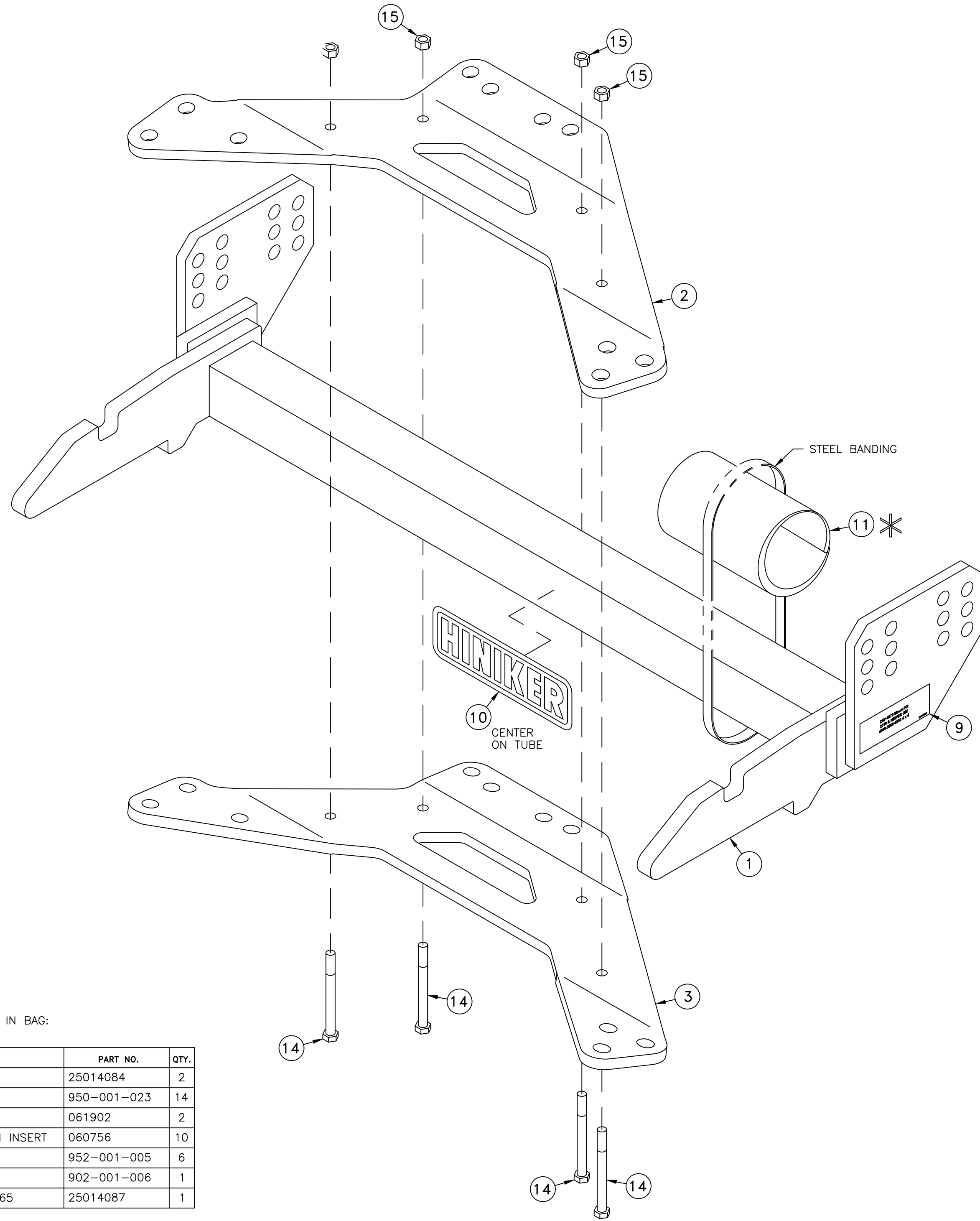

| NO. | PART NAME | PART NO. | QTY. | DWG. SIZE |
|-----|------------------------------|-------------|------|-----------|
| | BOLT BAG | 25014088 | 0 | ~ |
| 15 | HEX NUT 3/8-16 | 951-001-005 | 4 | ~ |
| 14 | HHCS 3/8-16 X 4 GR. 5 | 950-001-084 | 4 | ~ |
| 13 | INST SHT/MT KIT GM 45-65 | 25014087 | 1 | I |
| 12 | BAG 9 X 12 ZIP LOCK | 902-001-006 | 1 | ~ |
| 11 | BAG POLY WOVEN 12 X 20 | 902-001-012 | 1 | A |
| 10 | ID LABEL GM 45-65 19&NWR 4WD | 25014086 | 1 | A |
| 9 | HINIKER DECAL | 25010008 | 1 | B |
| 8 | LOCK WASHER 5/8 INCH | 952-001-005 | 6 | ~ |
| 7 | LOCK NUT 5/8-11 NYLON INSERT | 060756 | 10 | ~ |
| 6 | HHCS 5/8-11 X 4 GR. 8 | 061902 | 2 | ~ |
| 5 | HHCS 5/8-11 X 2 GR. 5 | 950-001-023 | 14 | ~ |
| 4 | NUT PLATE | 25014084 | 2 | A |
| 3 | RH BRACKET 4WD | 25014083 | 1 | C |
| 2 | LH BRACKET 4WD | 25014082 | 1 | C |
| 1 | PRONG WELDMENT | 25012124 | 1 | B |

REMOVE ALL SHARP CORNERS AND BURRS.
TOLERANCE UNLESS OTHERWISE SPECIFIED.
FRACTIONS ±1/32
DECIMALS ±.005
ANGLES ±1°
WELD ASSY. ±1/16

G45-102

HINIKER COMPANY MANKATO, MN 56001

| | | |
|-------------|------------|---------|
| MATERIAL | DRAWN BY | DATE |
| | CH | 8-28-19 |
| | CHECKED BY | DATE |
| DK | 9-9-19 | |
| APPROVED BY | DATE | |

| | | |
|----------|------------------|---------|
| CAD NO. | RELEASED ECO NO. | DATE |
| 25014079 | 8583 | 9-30-19 |

TITLE MT KT OP GM 19 & NEWER 45-65 4WD

| | | |
|---------------|----------|------|
| SCALE 1/4"=1" | PART NO. | REV. |
| | 25014079 | A |

NOTE:

* = PARTS INCLUDED IN BAG:

| NO. | PART NAME | PART NO. | QTY. |
|-----|------------------------------|-------------|------|
| 4 | NUT PLATE | 25014084 | 2 |
| 5 | HHCS 5/8-11 X 2 GR. 5 | 950-001-023 | 14 |
| 6 | HHCS 5/8-11 X 4 GR. 8 | 061902 | 2 |
| 7 | LOCK NUT 5/8-11 NYLON INSERT | 060756 | 10 |
| 8 | LOCK WASHER 5/8 INCH | 952-001-005 | 6 |
| 12 | BAG 9 X 12 ZIP LOCK | 902-001-006 | 1 |
| 13 | INST SHT/MT KIT GM 45-65 | 25014087 | 1 |