

VEHICLE INSTALLATION INSTRUCTIONS  
 DODGE RAM 4X4: 2019 & NEWER  
 2500/3500

Hiniker Company  
 58766 240th St.  
 P.O. Box 3407  
 Mankato, MN 56002

INSTRUCTION SHEET NO: 25014071

August 7, 2019



**IMPORTANT:** Read the Snowplow Operator's Manual before assembling this kit.

Minimum Vehicle Recommendations	
- Snowplow Prep Package	REAR BALLAST - 500 lbs. when plow is attached. Secure Weight Behind Rear Axle.

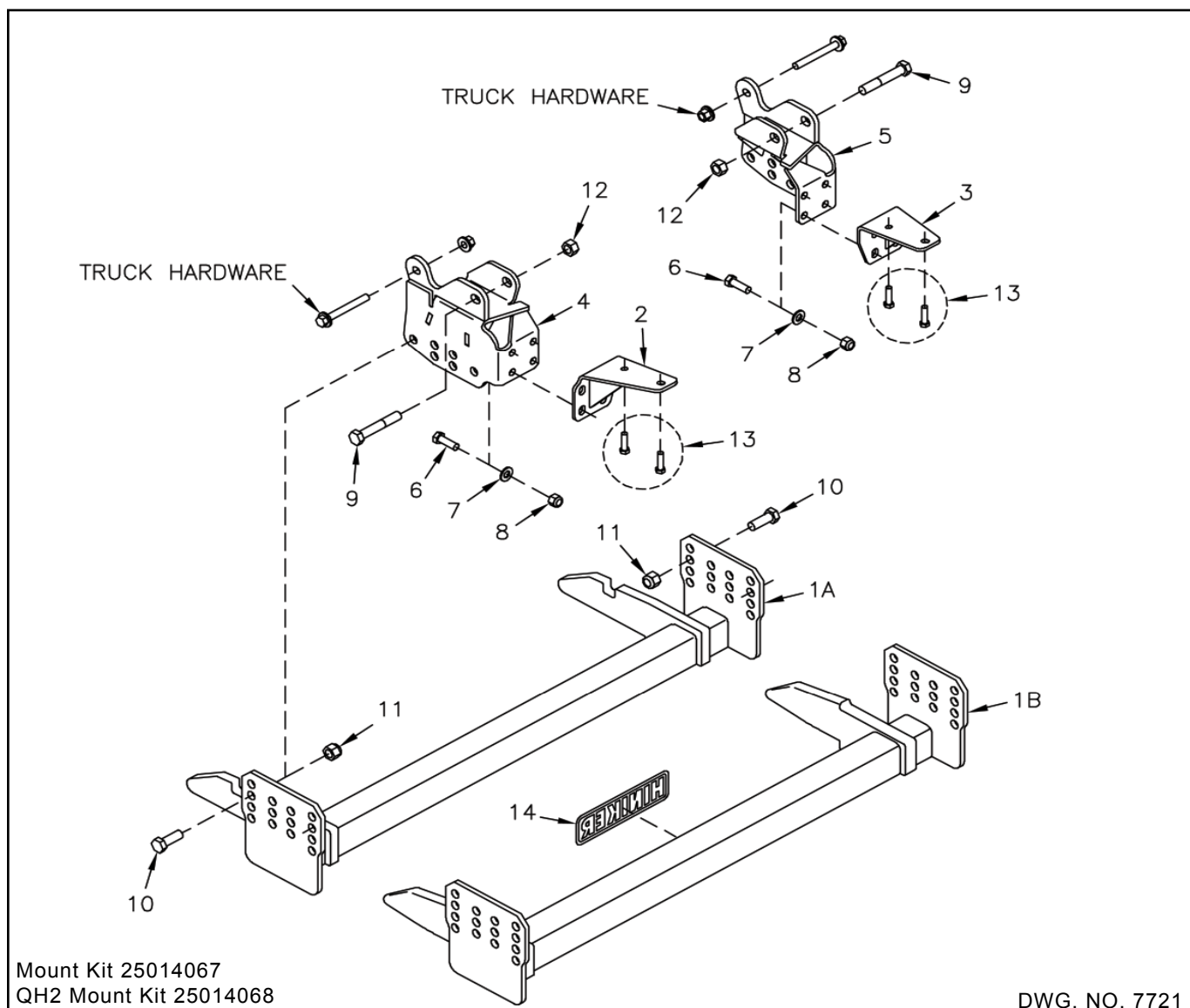

Mount Kit 25014067  
 QH2 Mount Kit 25014068

DWG. NO. 7721

REF. NO.	PART NUMBER	DESCRIPTION	QTY.	REF. NO.	PART NUMBER	DESCRIPTION	QTY.
1a	25010150	Prong Weldment	1	8	951-003-009	Lock Nut 1/2-13 Nylon Insert	8
1b	25012946	Prong Weldment-QH2	1	9	950-001-191	Hex Head Cap Screw 5/8-11 x 3 3/4 Gr. 5	2
2	25013281	LH Rear Bracket Weldment	1	10	950-001-132	Hex Head Cap Screw 5/8-11 x 1 3/4 Gr. 5	8
3	25013282	RH Rear Bracket Weldment	1	11	060756	Lock Nut 5/8-11 Nylon Insert	8
4	25014069	LH Bracket Weldment	1	12	951-005-044	Lock Nut 5/8-11, 2-Way	2
5	25014070	RH Bracket Weldment	1	13	950-011-058	Hex Head Cap Scr M10 x 1.5 x 35 Cl. 10.9	4
6	950-001-125	Hex Head Cap Screw 1/2-13 x 1 1/2 Gr. 5	8	14	25010008	Hiniker Decal	1
7	952-003-004	SAE Flat Washer, 1/2 inch	8		25013285	Bolt Bag	1

All hardware should be tightened only enough to ensure safety during assembly. Fully tighten all hardware after entire assembly is completed.

**GRADE 5 TYPE B & F LOCK NUT TORQUE VALUES**

Size	Ft-lbs.	N-m
5/16"	13-18	17-25
3/8"	23-33	31-44
1/2"	58-82	79-112
5/8"	117-165	158-223

**GRADE 5 BOLT TORQUE VALUES\***

Size	Ft-lbs.	N-m
1/4"	8-12	11-16
3/8"	29-41	39-56
1/2"	73-103	99-140
5/8"	146-206	198-279
* Applications without lock nuts		

1. Remove the lower plastic portion of the front truck bumper for clearance while assembling plow mount kit components onto the vehicle. Material will need to be trimmed away from the areas around the plow's attachment prongs before reinstalling plastic to the bumper later.

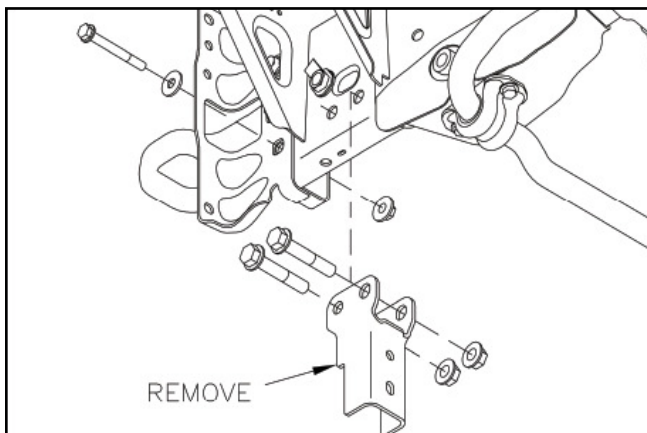

DWG. NO. 7722

If the truck is equipped with underframe channels shown in Drawing No. 7722, unbolt channels from both sides of the vehicle and return with hardware to the vehicle owner for reinstallation if the plow mount is removed in the future.

Remove the lower bumper bracket bolt from both sides of the vehicle and save for reinstallation.

2. Identify the LH and RH rear brackets from the mount kit.

**Important: Take great care not to cross-thread or strip threads in the vehicle frame!**

On one side of the vehicle at a time, remove two 10mm bolts that fasten the torsion bar bushing to the bottom of the vehicle frame. These four bolts will be replaced with longer bolts supplied with the mount kit.

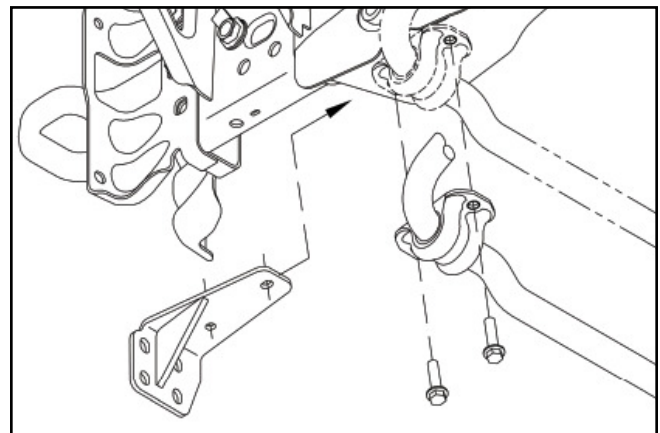

DWG. NO. 7723

Slide the rear brackets between the torsion bar bushings and the frame rails. Loosely fasten the assembly to the frame with M10 x 1.5 x 35 Class 10.9 hex bolts provided

3. Bolt the front holes of the LH and RH front brackets to the truck frame with lower tow hook bracket hardware removed earlier.

Insert a 5/8 inch x 3 3/4 inch hex bolt through the side hole in each bracket and secure with a two-way lock nut.

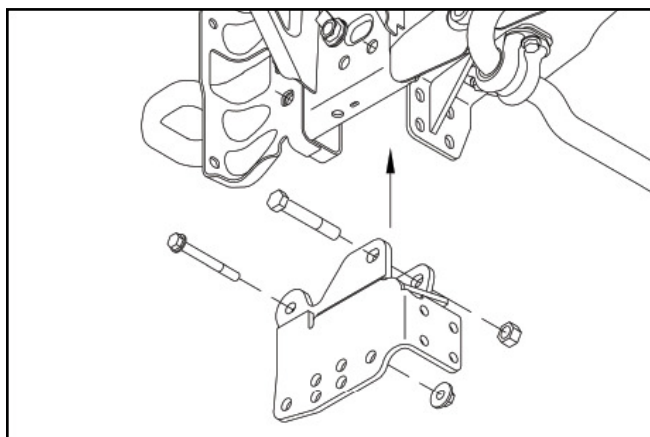

DWG. NO. 7724

Install four 1/2 inch x 1 1/2 inch hex bolts per side between the front and rear brackets. Loosely secure with 1/2 inch SAE flat washers and lock nuts.

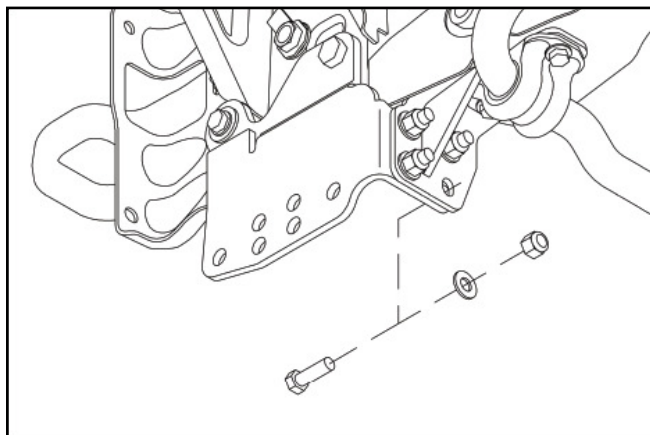

DWG. NO. 7725

4. Fasten the mount plates of the prong weldment to holes in the LH and RH brackets with 5/8 inch x 1 3/4 hex bolts and lock nuts.

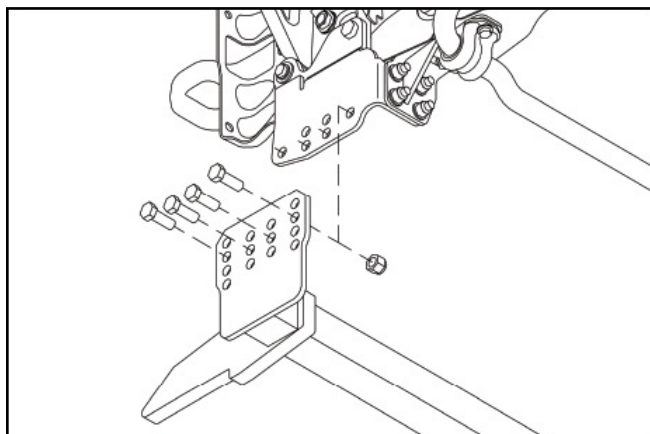

DWG. NO. 7726

Bottom edges of the prongs should measure about 10 inches above the ground. Ideally, the prongs should lift the plow frame slightly when driving into the plow.

5. Fully tighten all hardware to specified torque values.
6. Notch the front bumper plastic about 6 inches wide centered on the prongs to provide clearance for the receivers on the plow frame when attaching the plow to the truck. Remove only the least amount of material required for clearance to preserve the appearance of the truck.

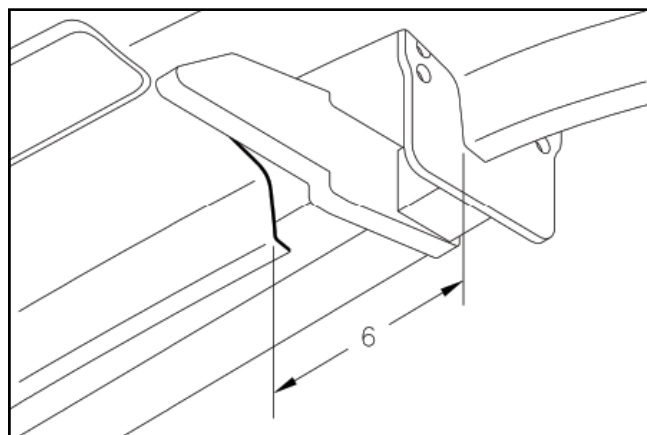

DWG. NO. 7727